



1:100 Scale



# Dragon's Trunk and Payload

## CRS-10

Print on Cardstock (110 lbs)

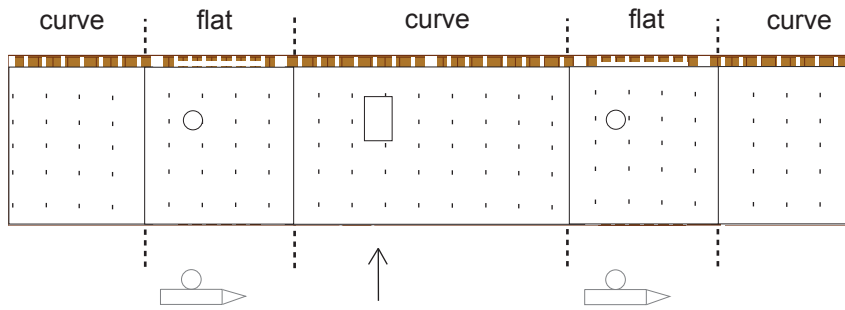
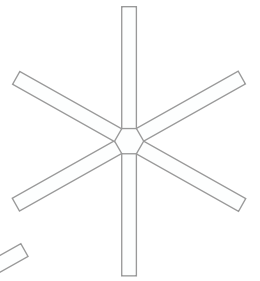
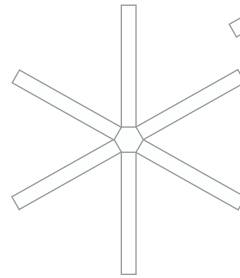
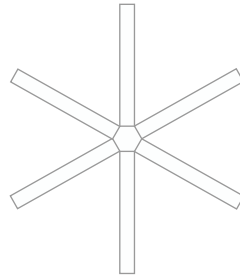
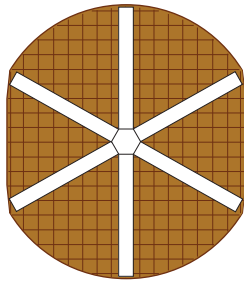

This curved area with the small rectangle is glued on the same side of the trunk that has the small rectangular box on the outside.

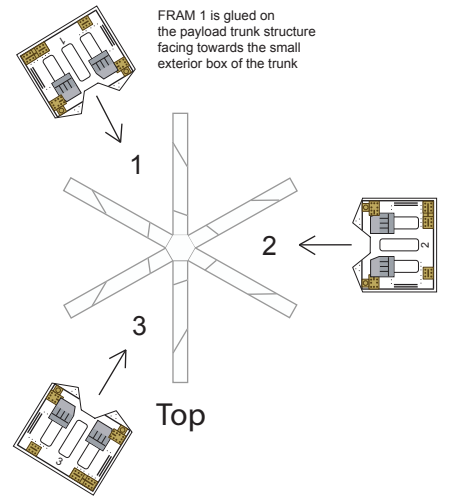

## SAGE III

Fram 2

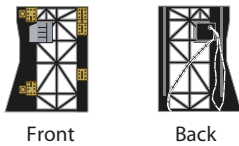
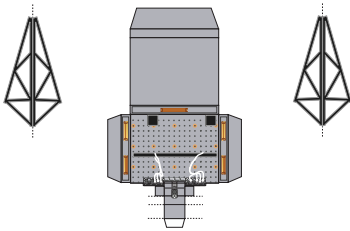

Fram 3

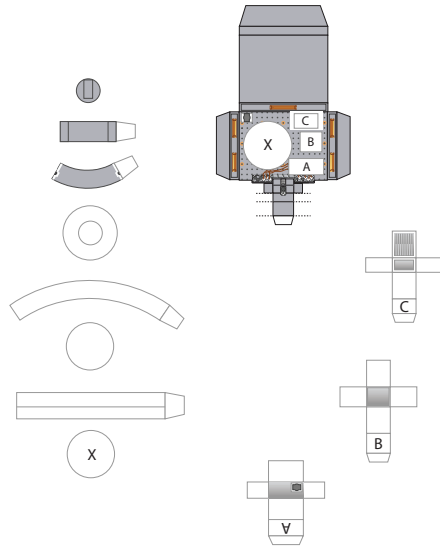

STP-H5

Fram 1

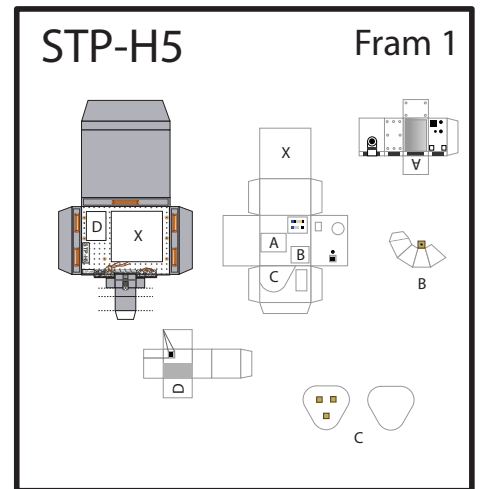



CRS-10 payload  
Diagram

Not to scale

Instrument  
FRAM 3

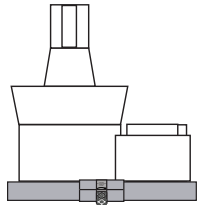

Front

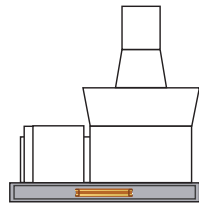

Back

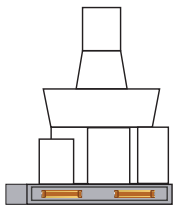

Side

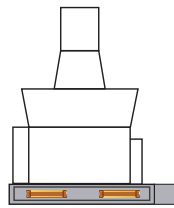

Side

Nadir Adapter  
Passive FRAM 2

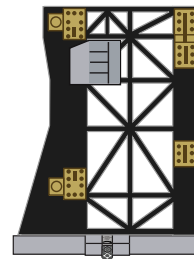

Front

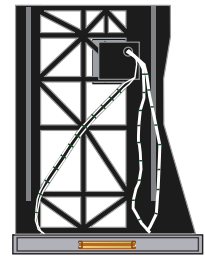

Back



Side

ELC-4

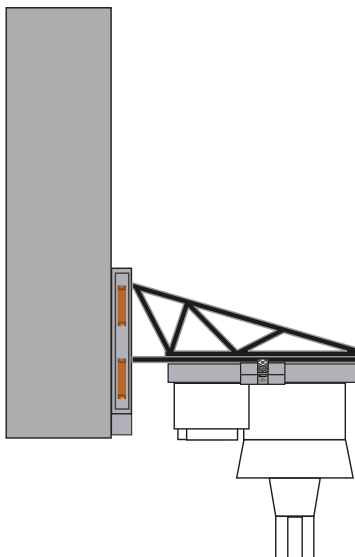

FRAM 1

